

STATE FLEET PARKING
& UNRESTRICTED PARKING

If you cannot find a place to park in the Visitor designated spaces in front of the Main Office at the National Life complex, you are welcome to park in undesignated spaces in front of the Davis Building, in the vertical spaces behind the parking garage, or on the various levels of the parking garage itself. After parking, proceed to the fourth level of the parking garage and exit via the pedestrian ramp from the parking deck to the front parking lot. Follow the sidewalk and enter the building through the Davis Building Entrance. There is also a lower lot on the right side of National Life Drive as you come up the hill from Route 2. After parking, you can then walk to the second level of the parking garage at the rear of the parking garage and proceed to the fourth floor as stated above.

Do not attempt to enter the Davis building via the pedestrian bridge on the top level of the parking garage as this entry requires a CASI card for access.

565 spaces @ 9'0"
100 spaces @ 8'7"

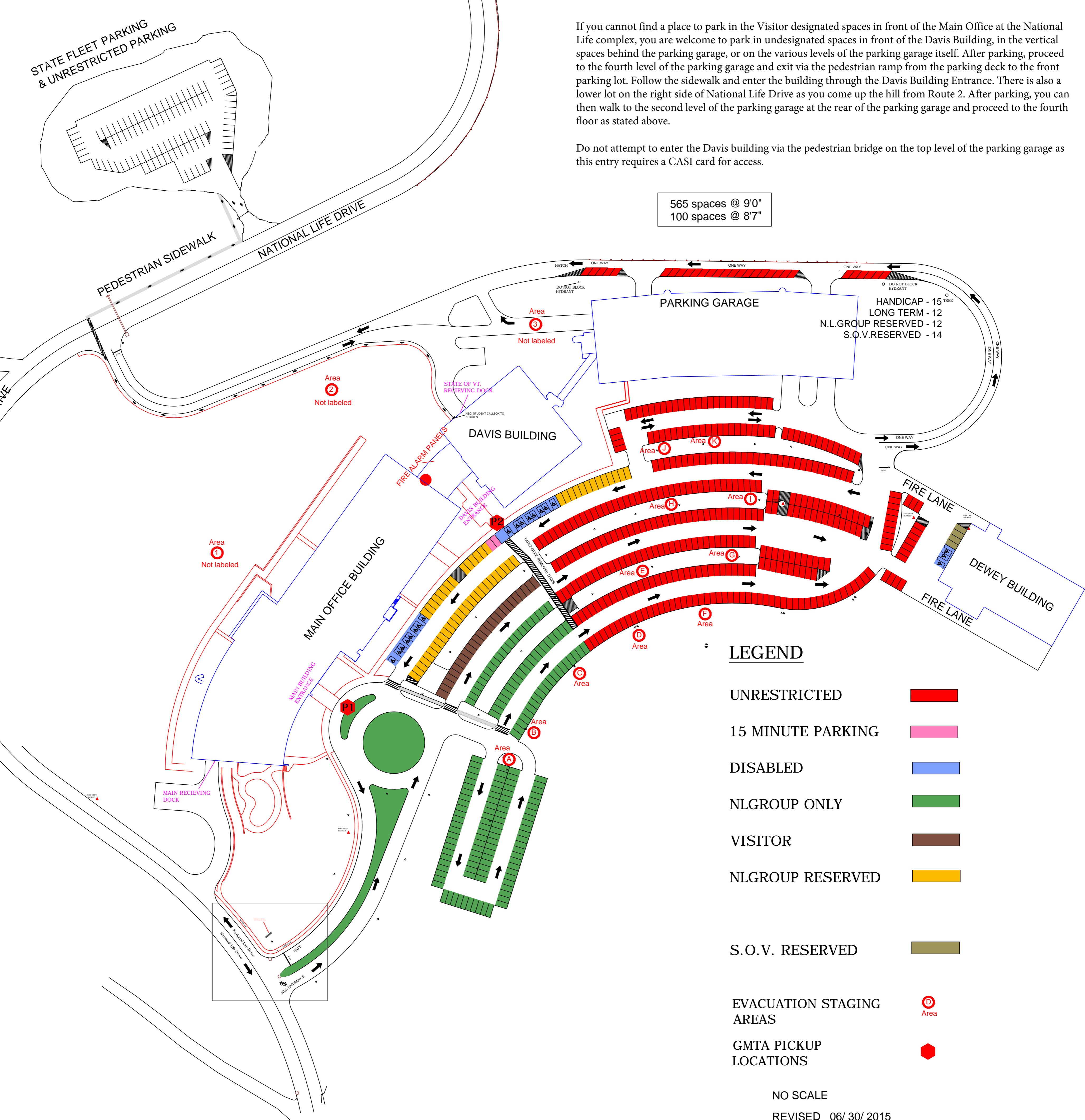

LEGEND

- UNRESTRICTED
- 15 MINUTE PARKING
- DISABLED
- NLGROUP ONLY
- VISITOR
- NLGROUP RESERVED
- S.O.V. RESERVED
- EVACUATION STAGING AREAS D
Area
- GMATA PICKUP LOCATIONS

NO SCALE
REVISED 06/30/2015

NATIONAL LIFE CAMPUS PARKING DESIGNATION